

**Assembly
instructions
shelving &
sideboards**
from
Pickawood

| EN |

P02-0623

Preparation - Assembly.....	3
Preparation - small parts.....	4
Basic structure - construction scheme.....	8
Prepare components for assembly.....	9
Assembly - connection situations.....	11
Assembly - Basic structure - Construction diagram.....	12
Assembly - Adjusting and fixing.....	13
Assembly - doors, flaps and handles.....	15
Assembly - Adjusting and fixing - Opening mechanisms.	18
Assembly - drawers.....	20
Assembly - Hanging shelves.....	23
Assembly - Notes.....	24

Carefully unpack all the boxes. Sort the individual parts according to shape and size. We recommend that you carry out the assembly with a **second person**.

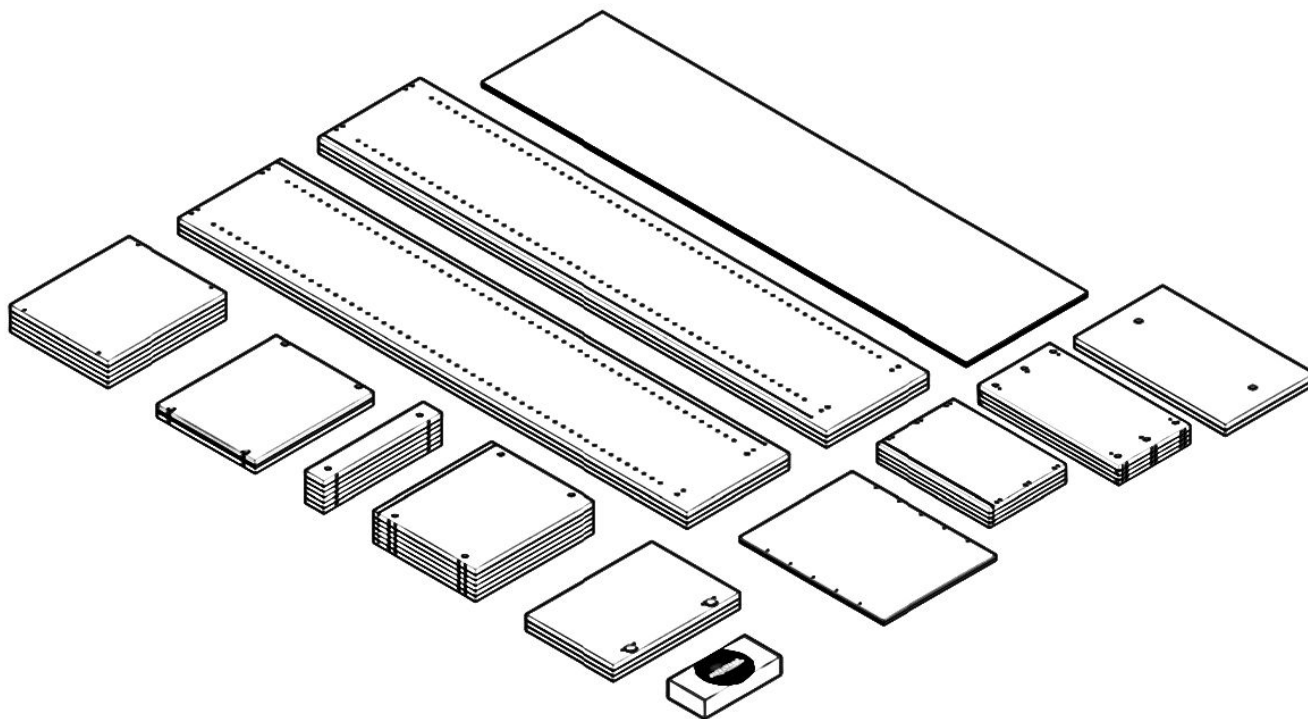

Tools - it is advisable to provide the required tools in advance and to assemble with 2 people. We recommend a hammer, a spirit level and a screwdriver for the assembly, if available, a cordless screwdriver with the appropriate attachment (bit).

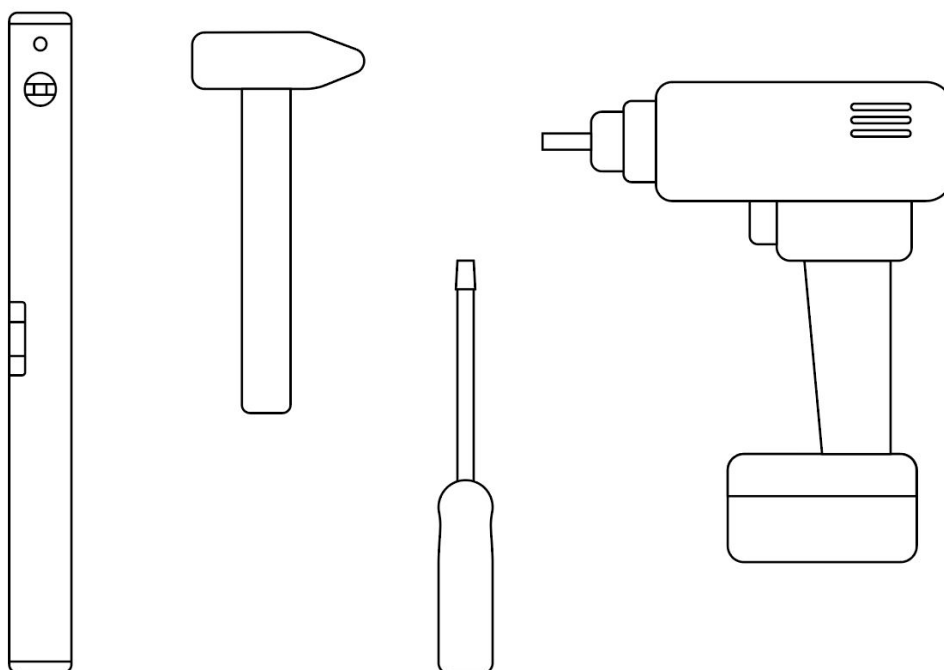

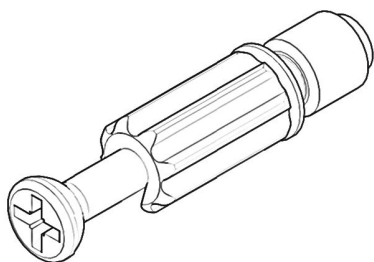

V01

Structure connector dowel
(eccentric)

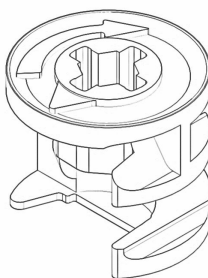

V02

Structure connector
housing (eccentric)

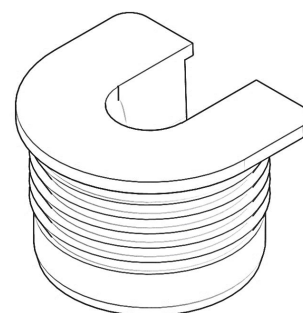

V03

Shelf connector housing

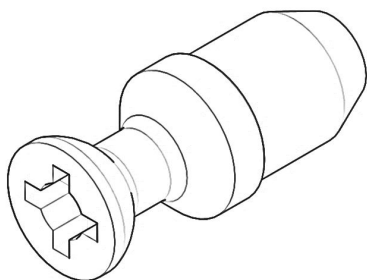

V04

Shelf connector dowel

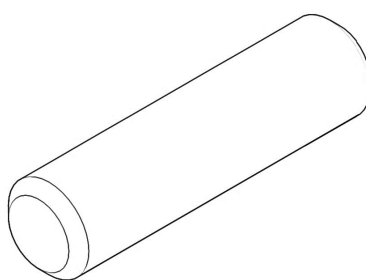

V05

Wood dowel

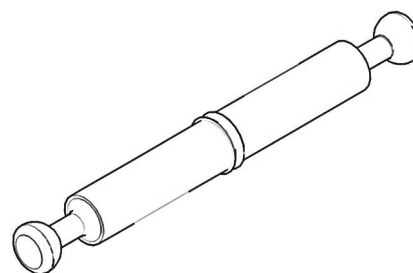

V06

Surface connector dowel
(double eccentric)

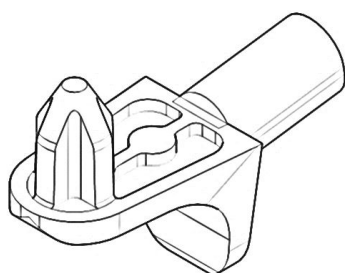

V07

Shelf support for strip with
mounting holes

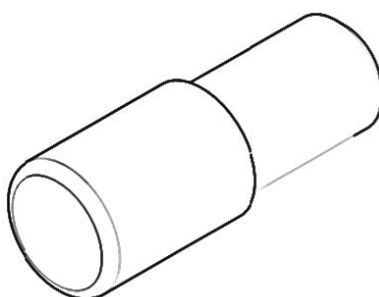

V08

Glass shelf support / door
stop

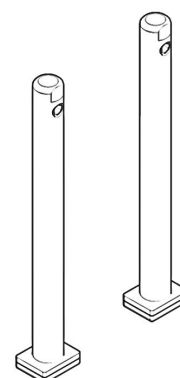

V09

Height adjuster

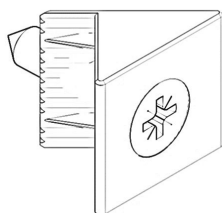

V10

Back panel corner mount

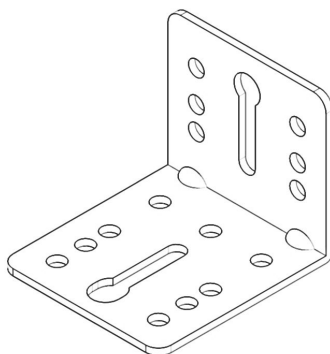

V11

Mounting bracket (anti-tilt)

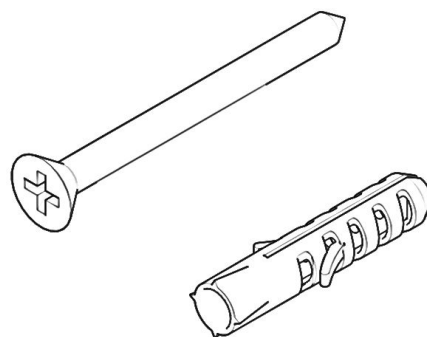

V12

Screws & dowels

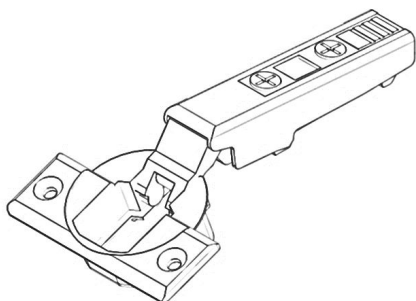

V13

Hinges

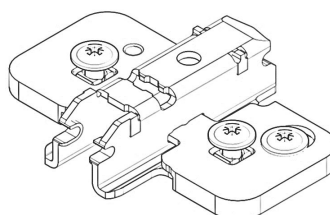

V14

Base / support for hinge

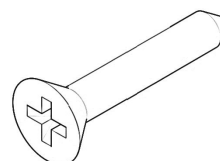

V15

Wood screw
Ø4x16mm

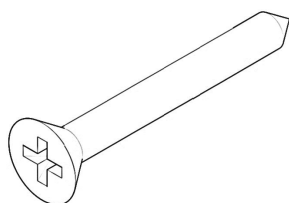

V16

Wood screw
Ø4x25mm

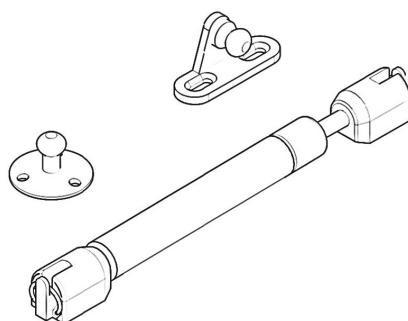

V17

Flap connectors - set

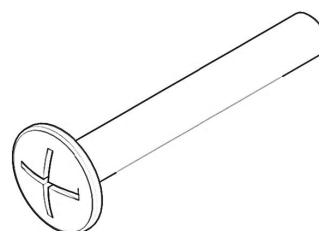

V18

M4 threaded screw

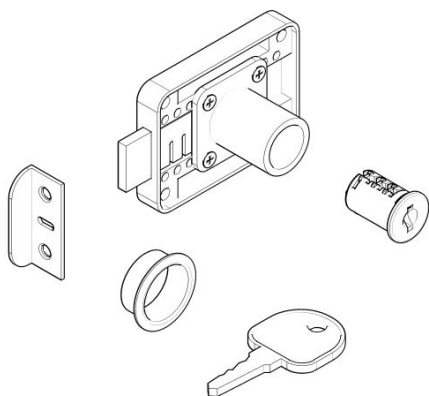

V19

Furniture lock

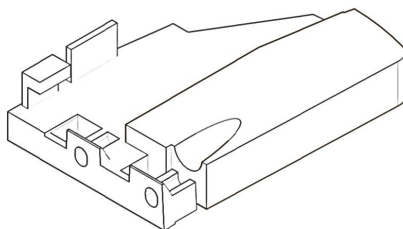

V20

Fixing clip for drawer guides

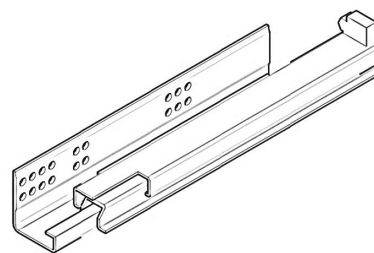

V21

Drawer rail

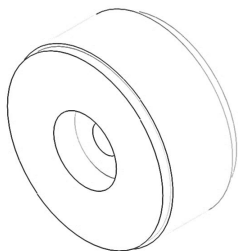

V22

Adjustment lock for front panel

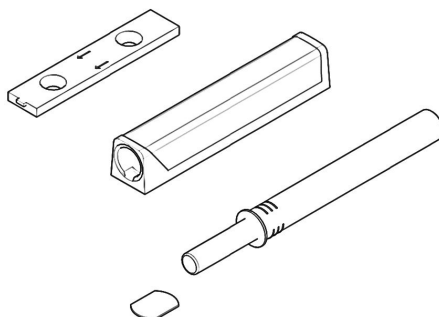

V23

Push-To-Open - Set (door / flap)

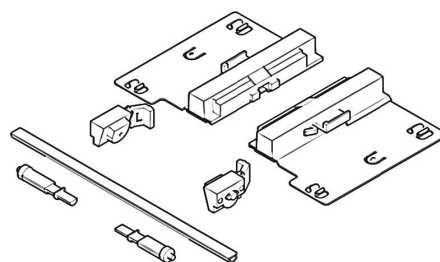

V24

Push-To-Open - Set (drawer)

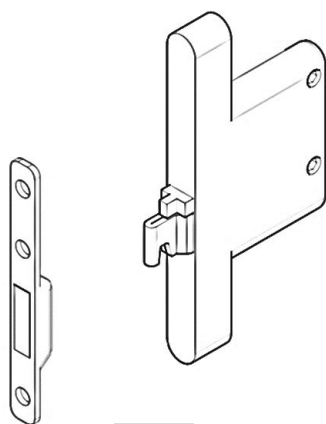

V25

Wall mount for hanging shelf

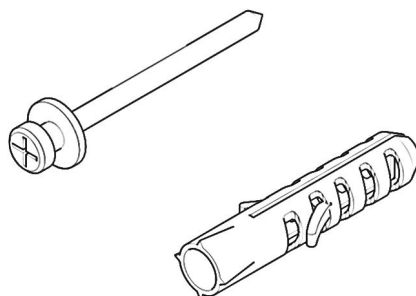

V26

Screw & dowel wall mounting for wall cube

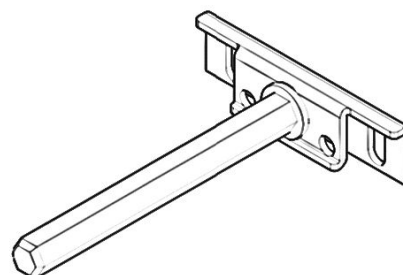

V27

Wall mount for wall shelving boards

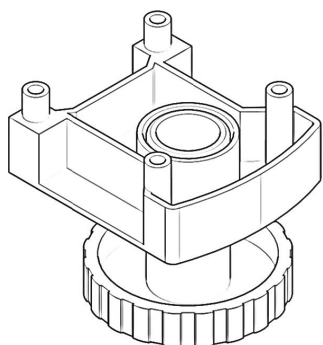
**V31**

Base - height adjuster

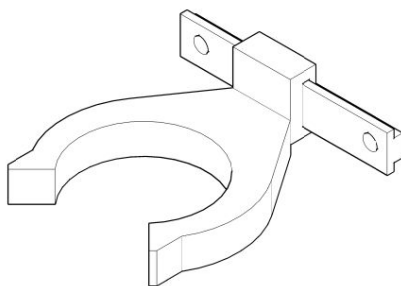
**V32**

Coupling drawer runner

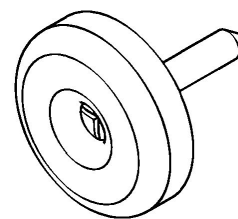
**V33**

Furniture glides

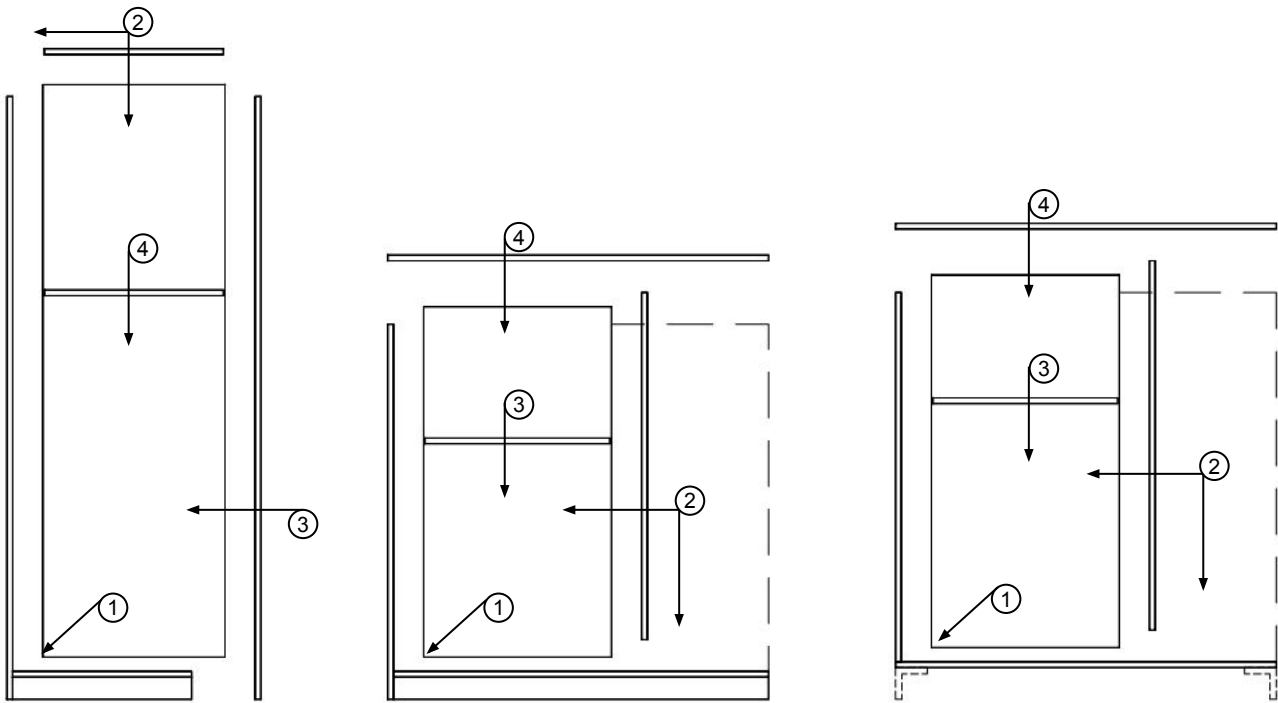

For easy assembly, **assemble** the furniture **from left to right**. Start with the left exterior and connect it to the base. Depending on the construction outline (please refer to your furniture configuration) continue with the assembly steps outlined.

Preparing components for assembly

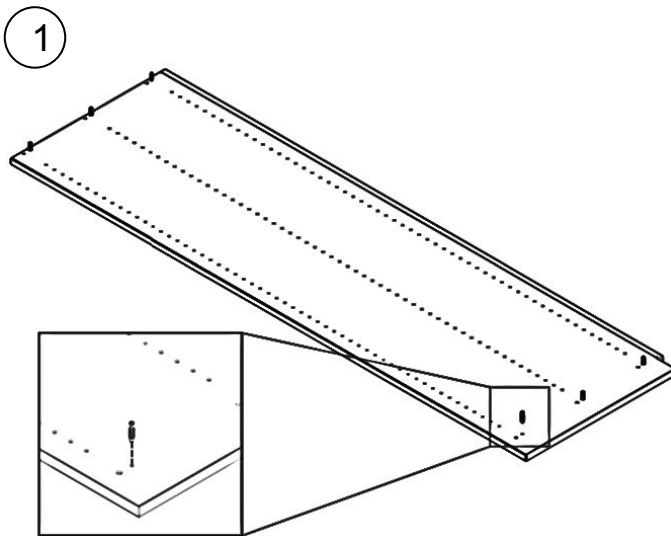

V01

Screw the structure connector dowels (V01) into the **sides**.

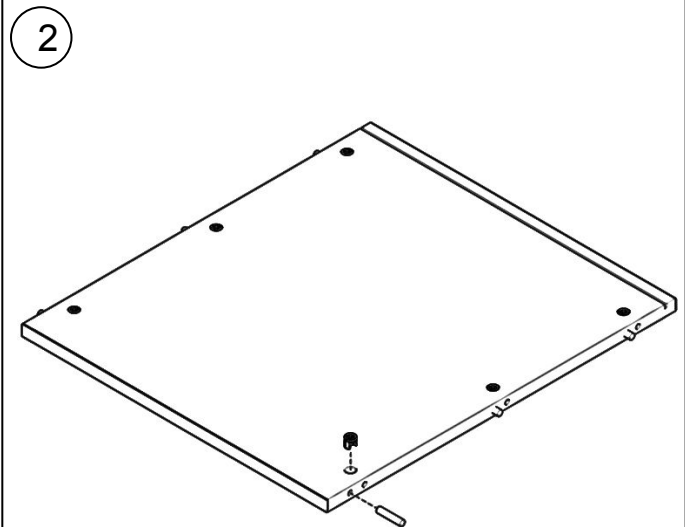

V02

V05

Press the carcass connector housings(V02) and the wooden dowels(V05) into the top and bottom shelves. **!Attention!** For continuous bottom panel, with height adjusters, see page 14.

3

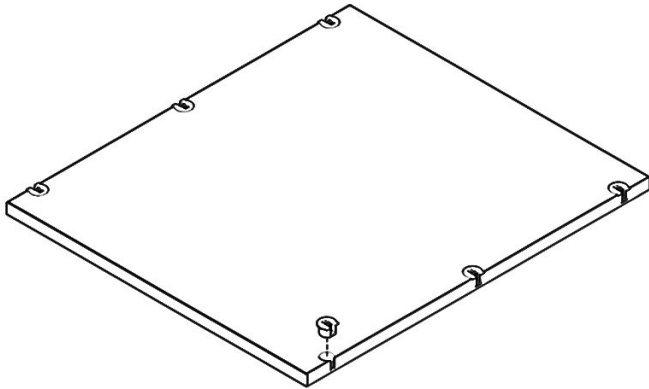

V03

Press the shelf connector housings (V03) into the **shelves**. We recommend using a hammer with a rubber head for this purpose.

4

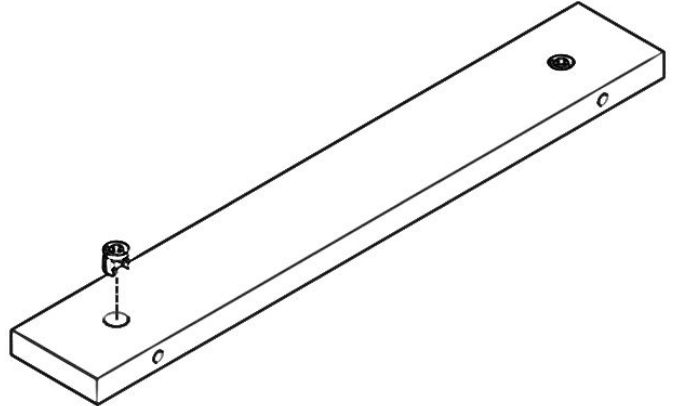

V02

Press the housings of the structure connector (V02) into the **base panels**.

5

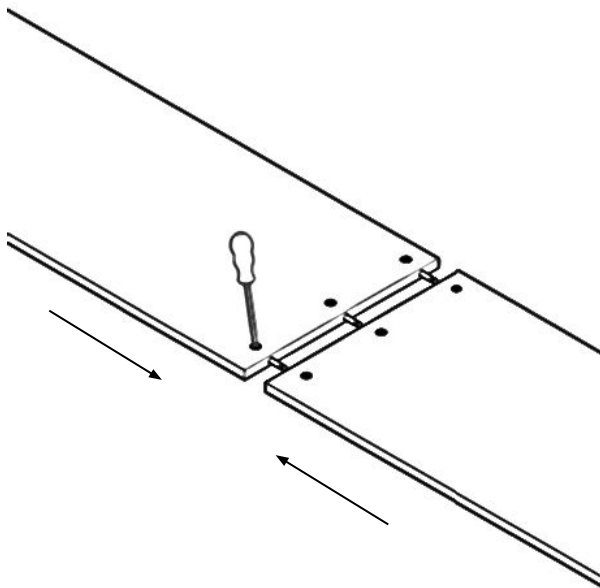

V02 V06

Long components are divided into two parts and are connected with surface connectors (V06).
Important Note: Tighten the connector housings (V02) gradually and alternately, otherwise they may not grip properly.

6

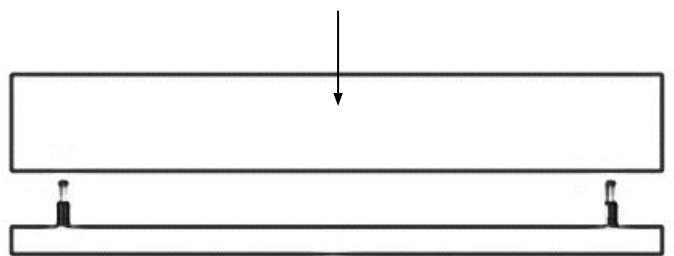

V01 V02

Plug the **base panels** onto the inverted **bottom panel**. Carefully tighten the structure connectors (V02) firmly.

7

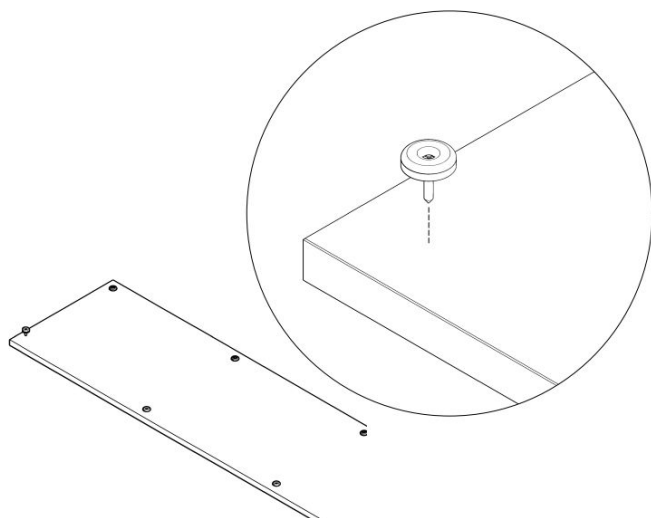

V33

If you have not configured a plinth or sideboard feet, we will send you optional furniture glides for screwing. These are screwed into the underside with a screwdriver.

!Attention! No pilot holes are prepared here.

1

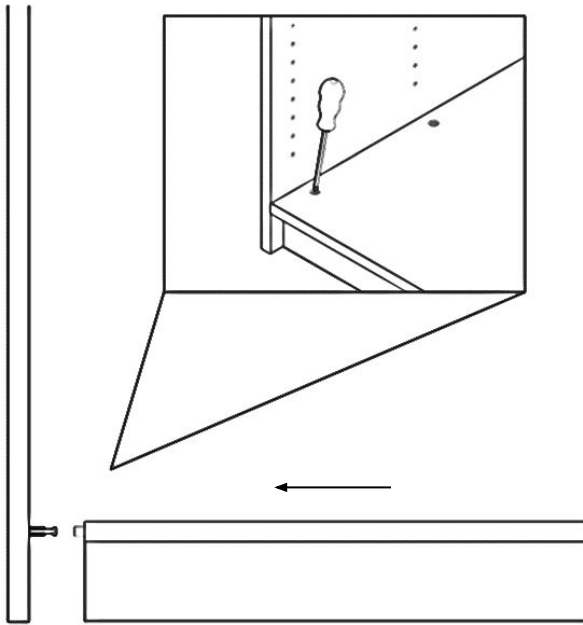

Slide the bottom panel with the plinth panel to the left cheek and fix the components by tightening the carcass connector housing (V02).

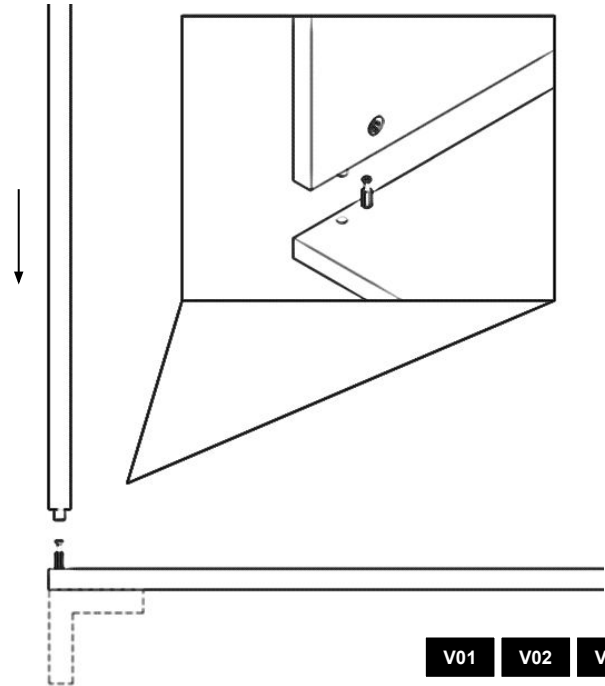

If your furniture does **not** have a **base**, plug the stringers directly onto the bottom panel and fix the structure connector housing (V02) with a screwdriver.

2

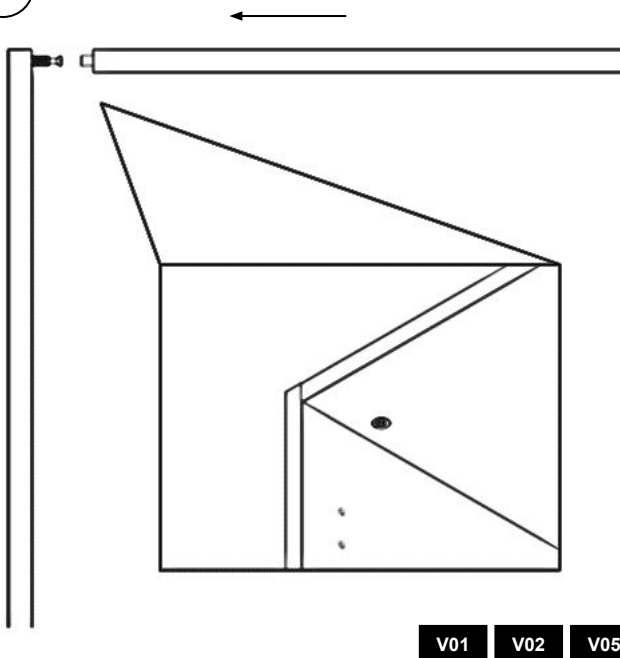

Then slide on the **top shelf** and fix the structure connector housing (V02).

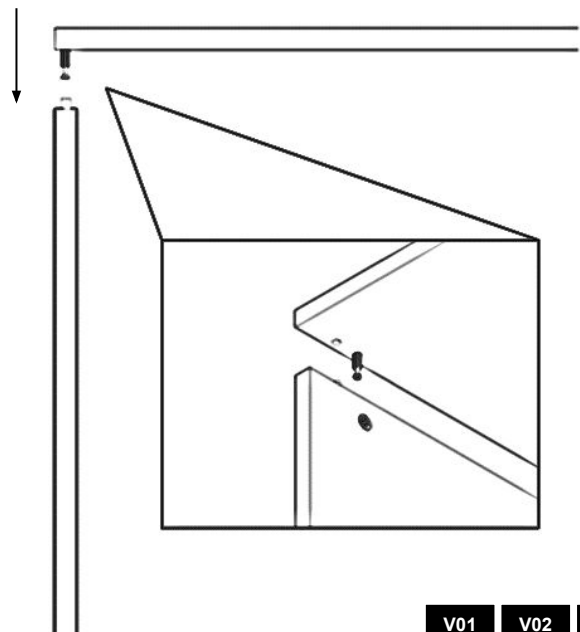

If you have a continuous top shelf, insert it from above and fix the structure connector housing (V02). **Important Note:** the top shelf should be left until the end of the assembly.

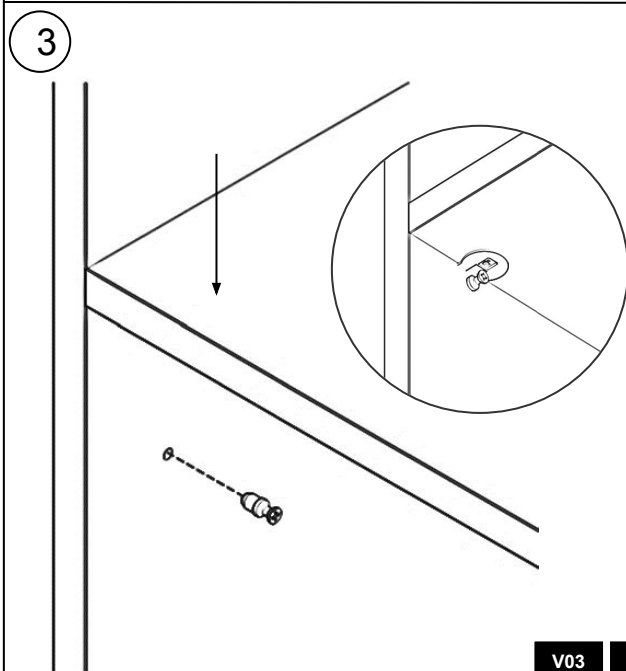

To insert the **shelves**, screw the shelf connector dowels (V04) into the stringers and slide the shelf onto them from above. Then fix the shelf connector housings (V03).

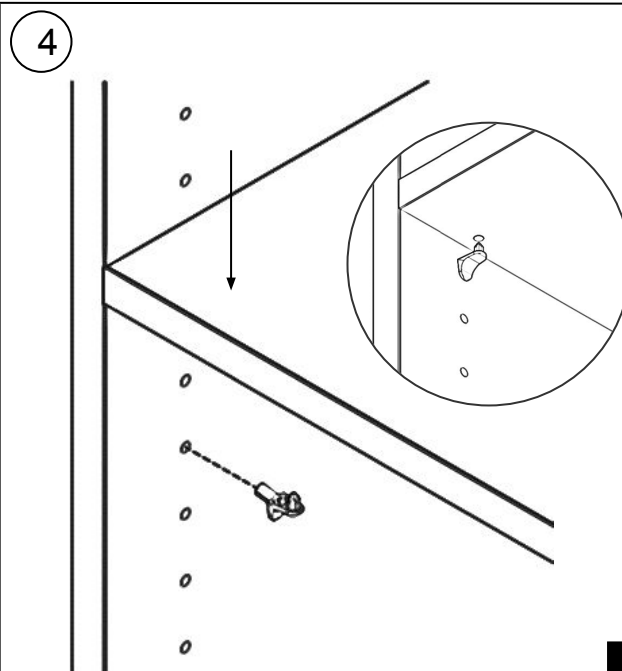

To insert **shelves into a strip** with mounting holes, insert the shelf support (V07) into the stringers and slide the shelf on top. **Important Note:** One shelf per column must be fixed according to **Step 3** to ensure your shelving has sufficient stability.

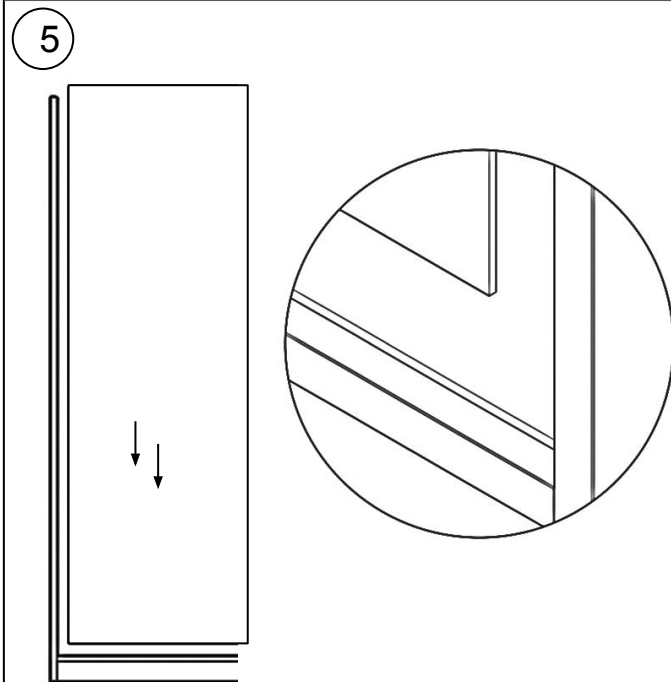

Slide the back panels into the grooves. Pay attention to the correct order of assembly. First place the bottom shelf, then the back panel and finally the top shelf against the stringer.

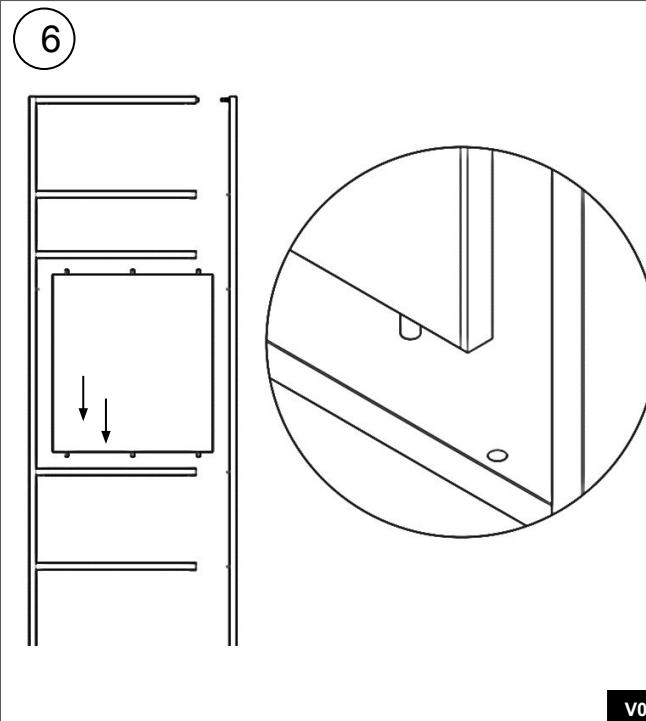

Solid back panels are fixed by inserting them into the dowel holes (V05).

I.
*Non-continuous top
& bottom panels*

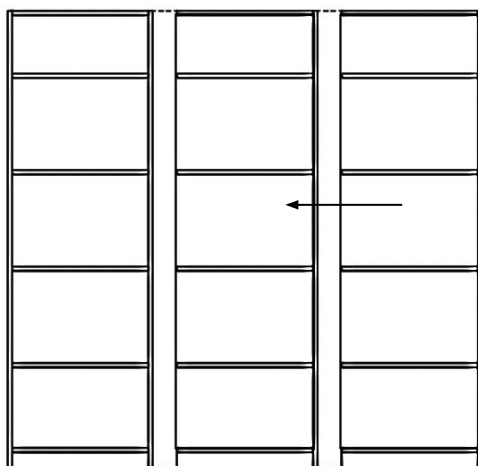

II.
*Continuous top & bottom panels with
base*

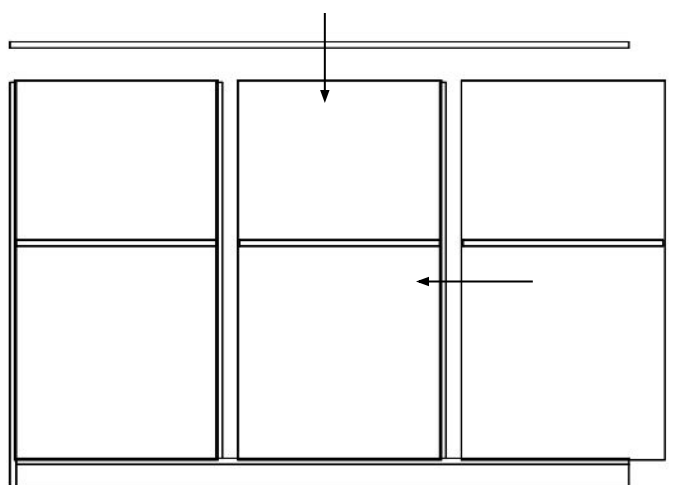

III.
*Continuous top & bottom panels
without base*

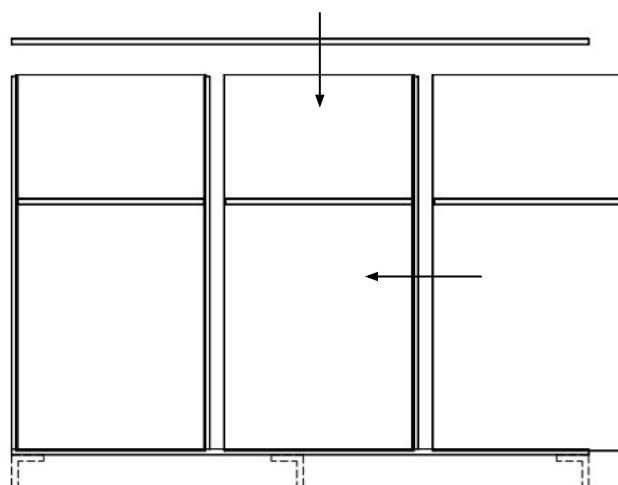

Repeat Steps 1-6 consecutively for each column. Observe the outlined procedure for split or continuous panels.

1

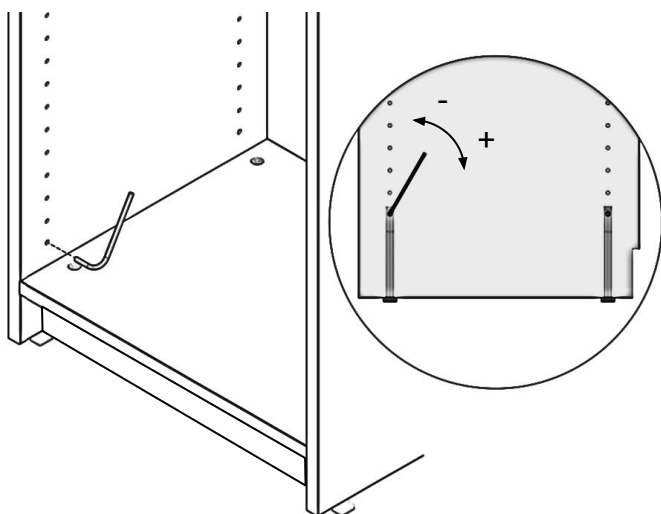

V09

Optional **height adjuster** (V09): Adjust the furniture with an Allen key and with the help of a spirit level.

2

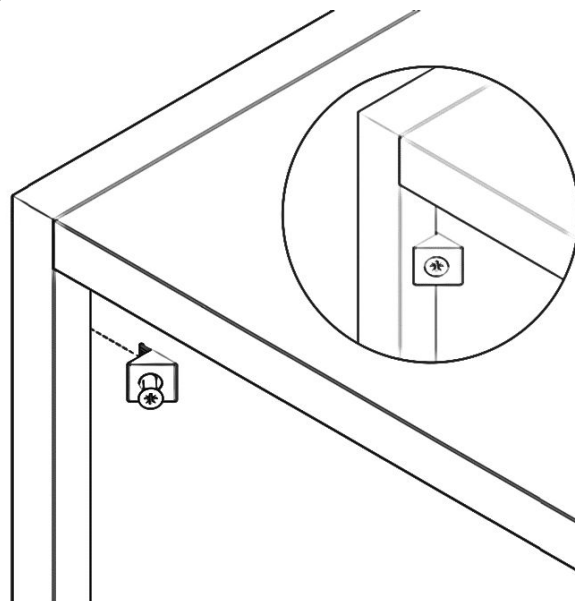

V10

To stabilise a back wall, insert the back wall brackets (V10) into the groove from behind. Then tighten the screws. We recommend an angle every 30 cm.

For niche furniture, the angles can also be attached from the inside or they can be omitted.

3

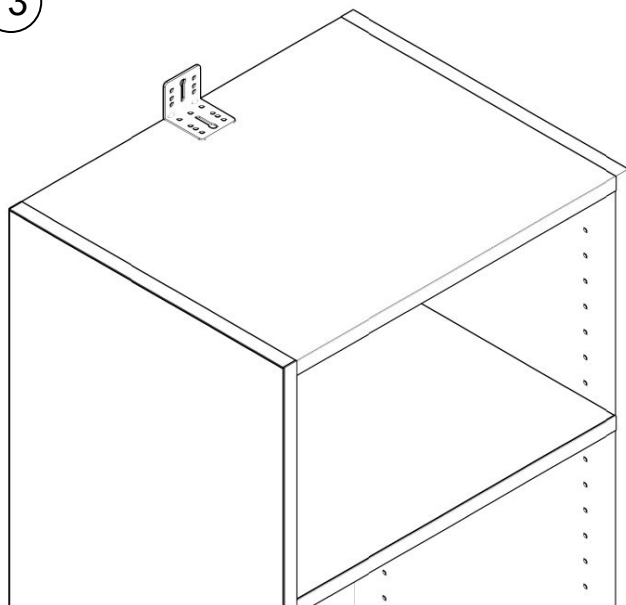

V11 V12 V15

Once you have stabilised and leveled the furniture, attach it to the wall using the anti-tip brackets (V11). Use the screws for the furniture (V15) and the wall (V12) for this purpose.

4

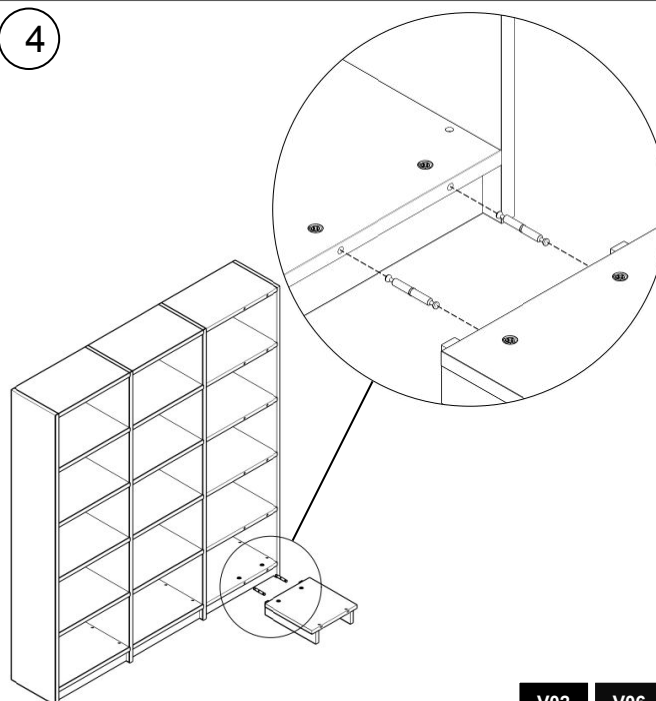

V02 V06

For corner constructions, connect the individual elements (e.g. the bottom panels) with the surface connectors (V02 - V06) during assembly. For this process, also refer to **Step 5** on page 8.

5

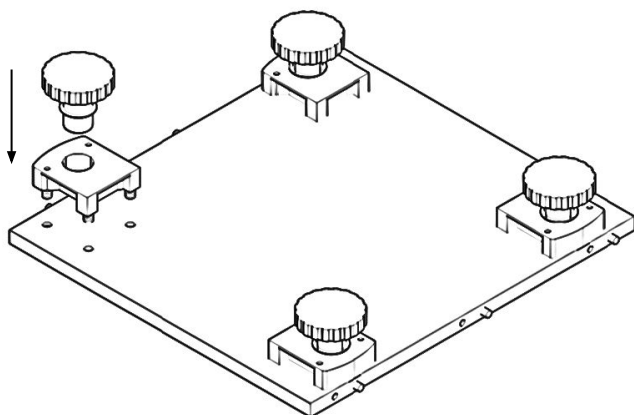

If the top and bottom plates are continuous, press the adapter plates and the plinth feet (V31) into the inverted bottom plate; it is worth using a hammer for this.

Attention: The rounding on the adapter plates must face outwards.

6

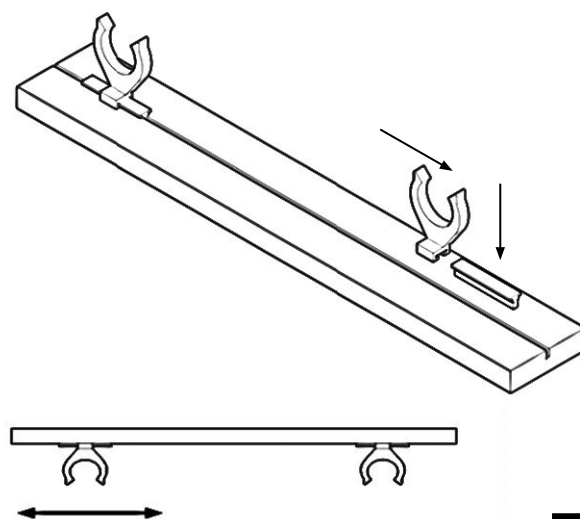

Grooves are then milled into the plinth panels, here you first press in the plinth clip guide and then push on the clip (V32).

7

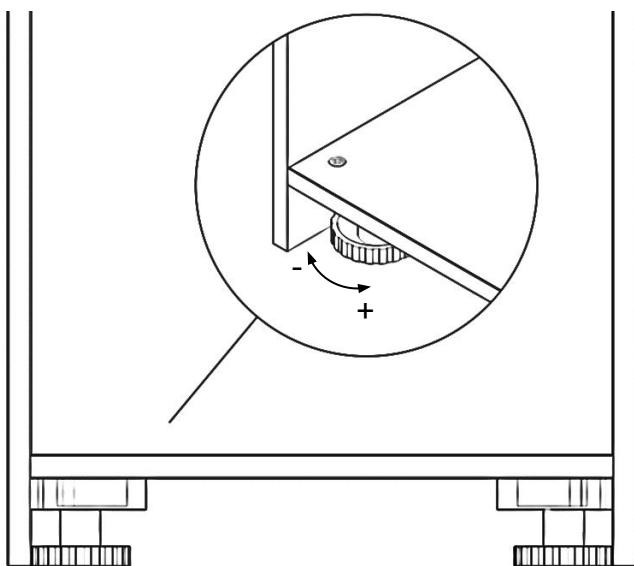

Align your furniture with the help of a spirit level. To do this, turn the plinth feet (V31) in or out.

8

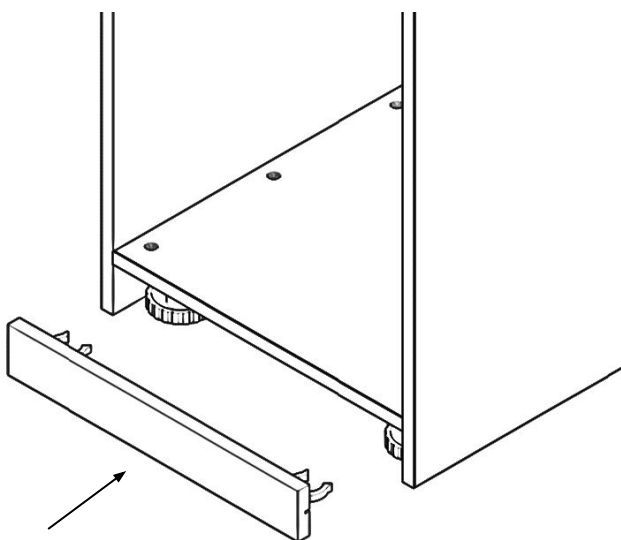

After you have levelled your furniture, slide the plinth panel including the clips (V32) onto the plinth feet (V31).

1

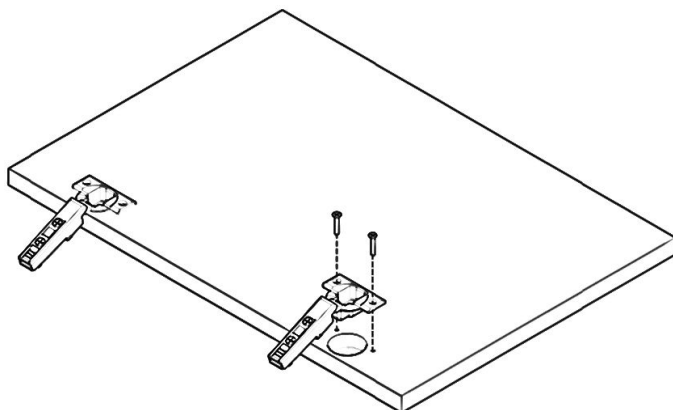

V13 V15

For **doors and flaps**, insert the hinges (V13) and screw (V15) them in place.

Corner hinge

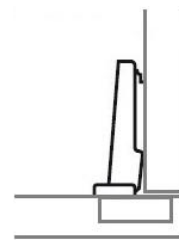

Central panel hinge

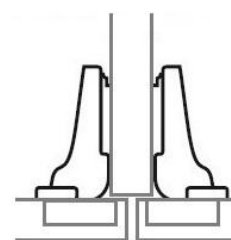

Inside hinge

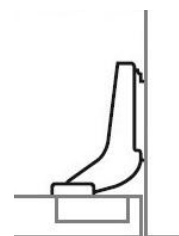

When actioning this, make sure to choose the right hinges. Match the mounting positions of the fronts.

2

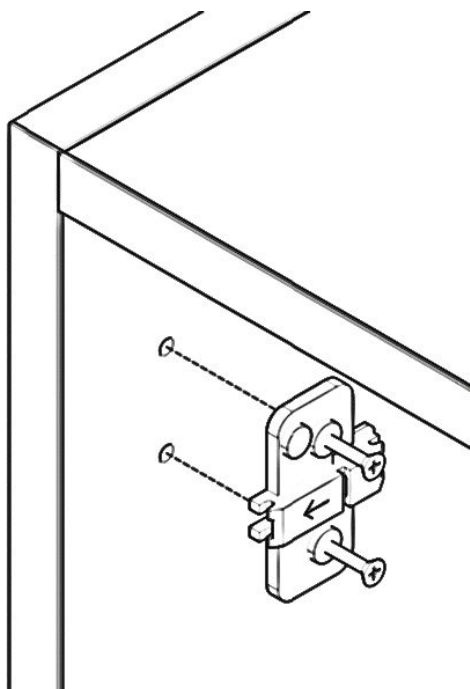

V14

Insert the mounting plates (V14) with the arrow pointing forwards and fasten them by fixing the screws.

3

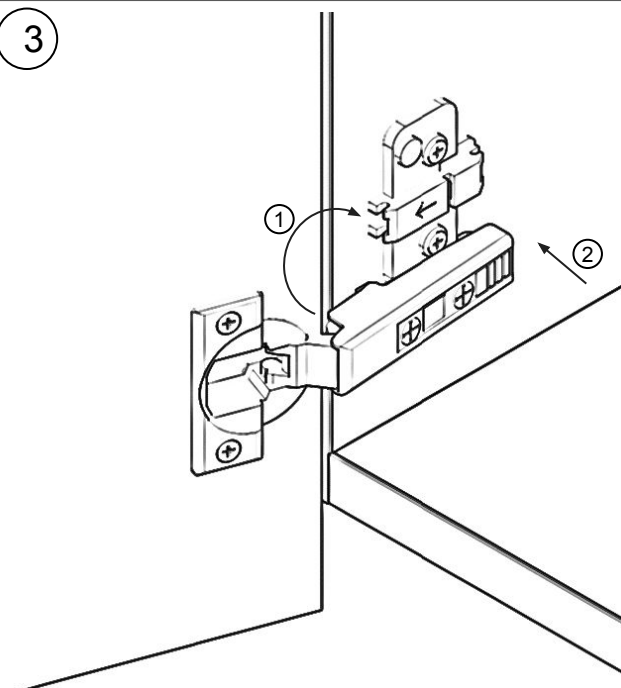

V13 V14

First place the hinges (V13) on the front edge of the mounting plate (V14). Then press the hinges firmly at the rear until the hinge engages.

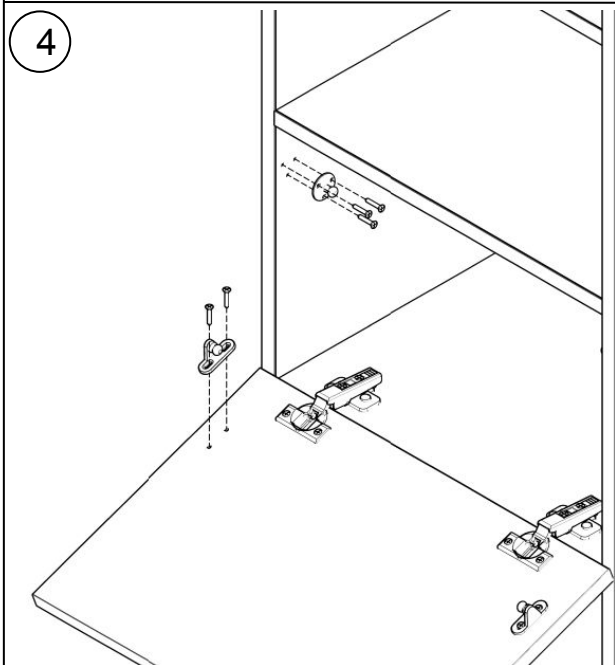

V15 V17

To properly mount a flap, first screw (V15) the mounting plates (V17) to the stringers and front.

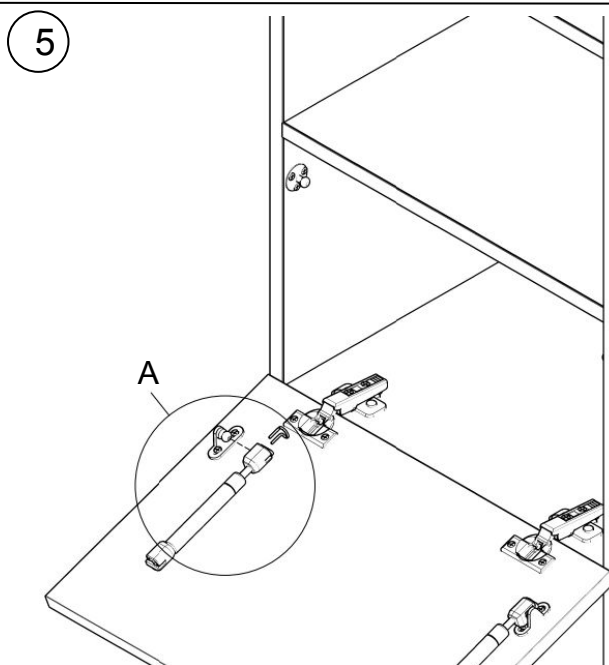

V17

When the mounting plates are fixed, first attach the flap fitting (V17) to the front. See **Detail A** for reference.

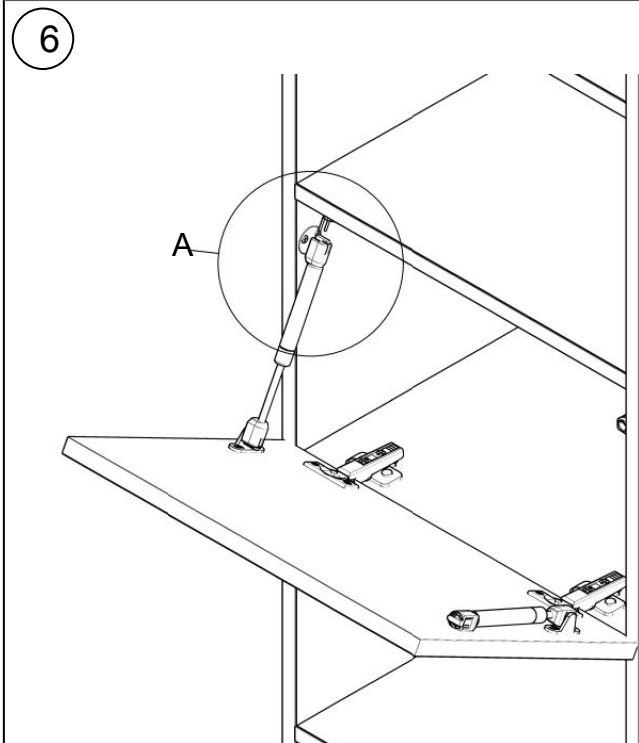

V17

Repeat this process (5) on the furniture cheek. See **Detail A** for reference.

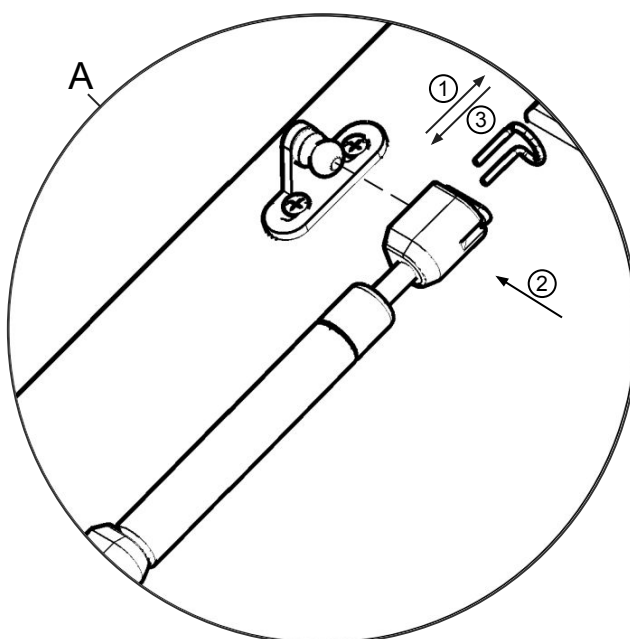

Fix the fitting:

1. Loosen the metal clamp
2. Place the fitting on the holder
3. Fix the fitting with the clamp

Upward opening hinged doors are also fixed in this way.

7

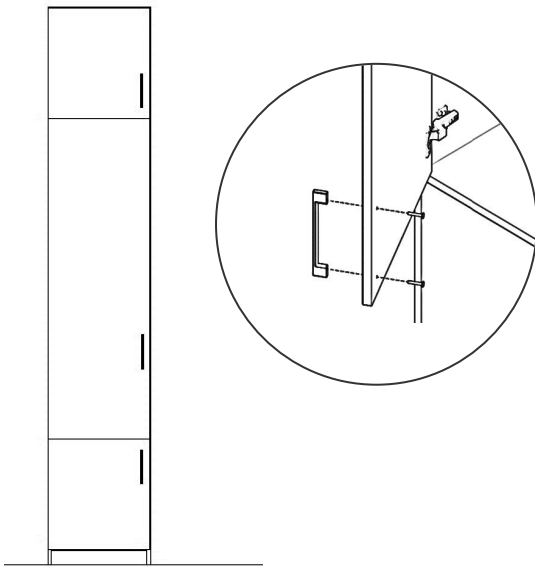

V18

Fasten the handles to the doors through the pre-drilled holes using the enclosed M4 screws (V18). **Important Note:** Use the shorter version of the screws (V18) for glass doors.

8

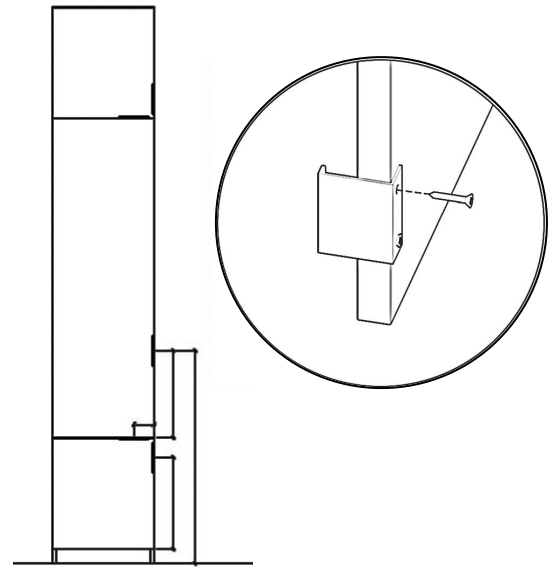

For handle 2 or 3, you can determine the position for yourself. Screw them in place at the back using the screws provided. The handles can also be mounted horizontally.

9

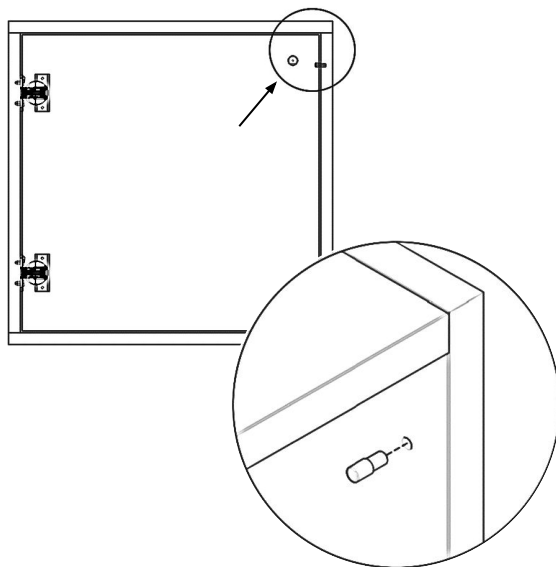

V08

For interior doors with handle, stop buffers (V08) are enclosed. Press them into the pilot holes.

Note: In the case of hinged doors, the stop buffers are fitted at the bottom edge of the door.

10

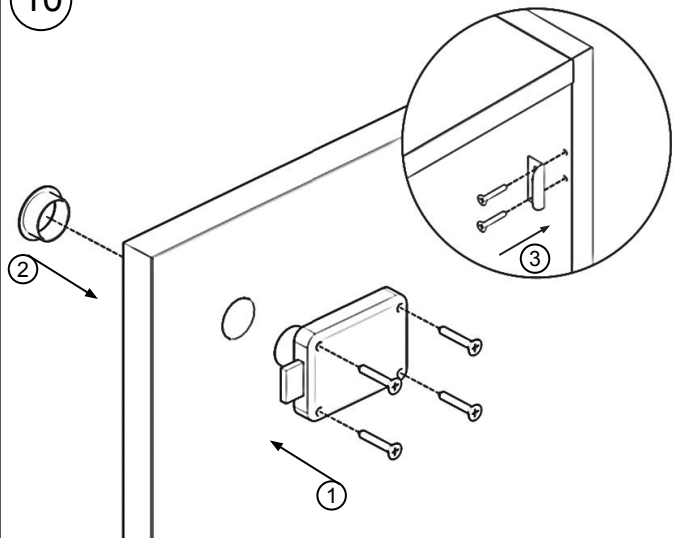

V19

Furniture locks (V19) are pressed into the hole from behind and screwed into place. Press the key rosette from the front and then screw the locking bracket to the stringers or the shelf.

Note: For hinged doors, screw the striker bar to the opposite door.

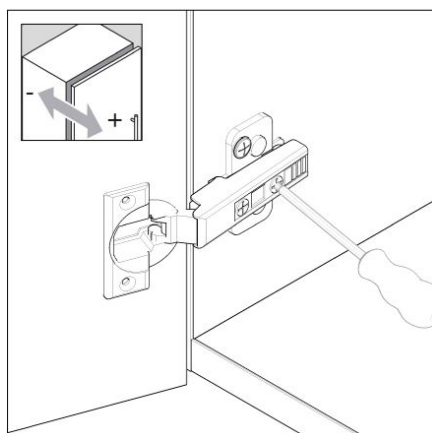

+3 / -2 mm

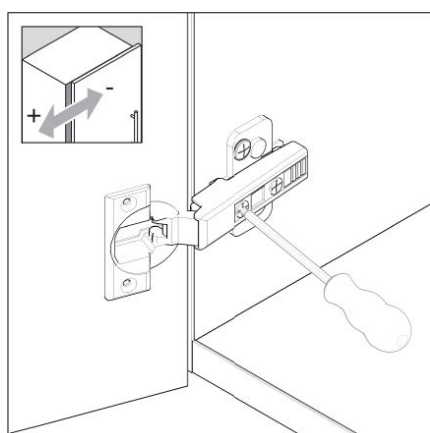

+/- 2 mm

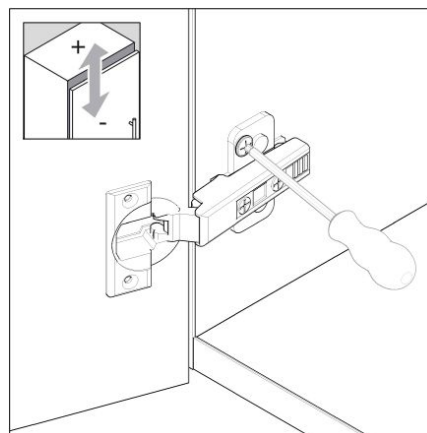

max. +/- 3mm

V13 V14

To adjust the joint pattern, you can use the adjustment options on the cup bands (V13) and the mounting plates (V14).

Note: Start with one front and align to a stringer. Then adjust and attach the other fronts to it.

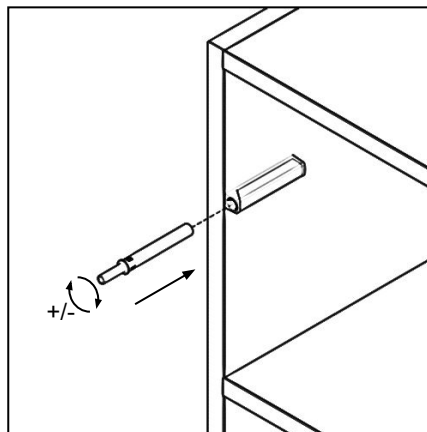
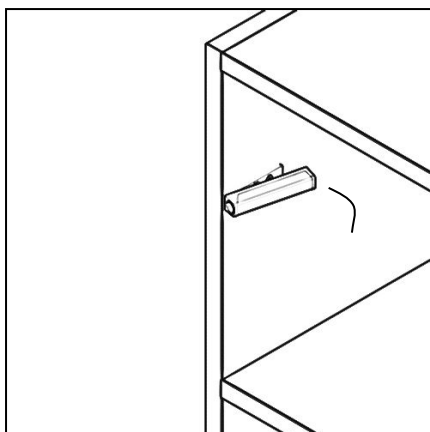
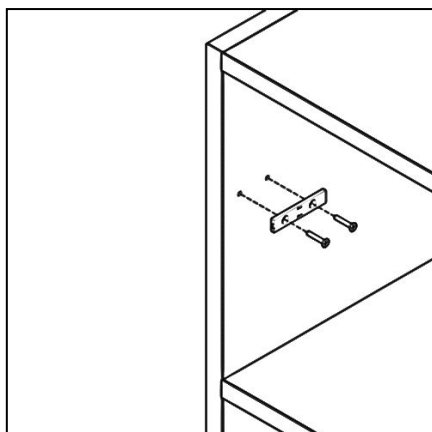

V15 V23

Mounting Push-To-Open (V23) for doors and flaps: First screw on the adapter plate with the wood screws (V15), making sure that the arrows point to the front edge. Then clip on the spring housing and push in the spring from the front.

Note: If you turn the front cylinder of the spring, you can adjust the depth.

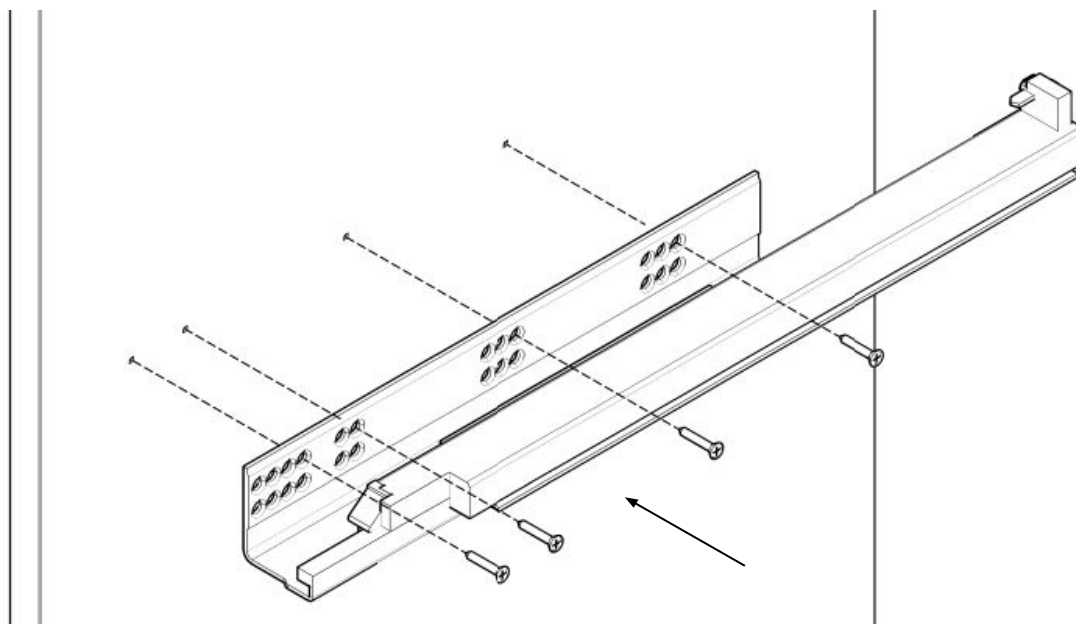

V15 V21

Use the wood screws (V15) to screw the drawer rails (V21) to the stringers of the furniture.
Use the fourth upper hole of the rails for the first hole in the stringboard. The other fastening points can be found in the predrilled holes in the stringers.

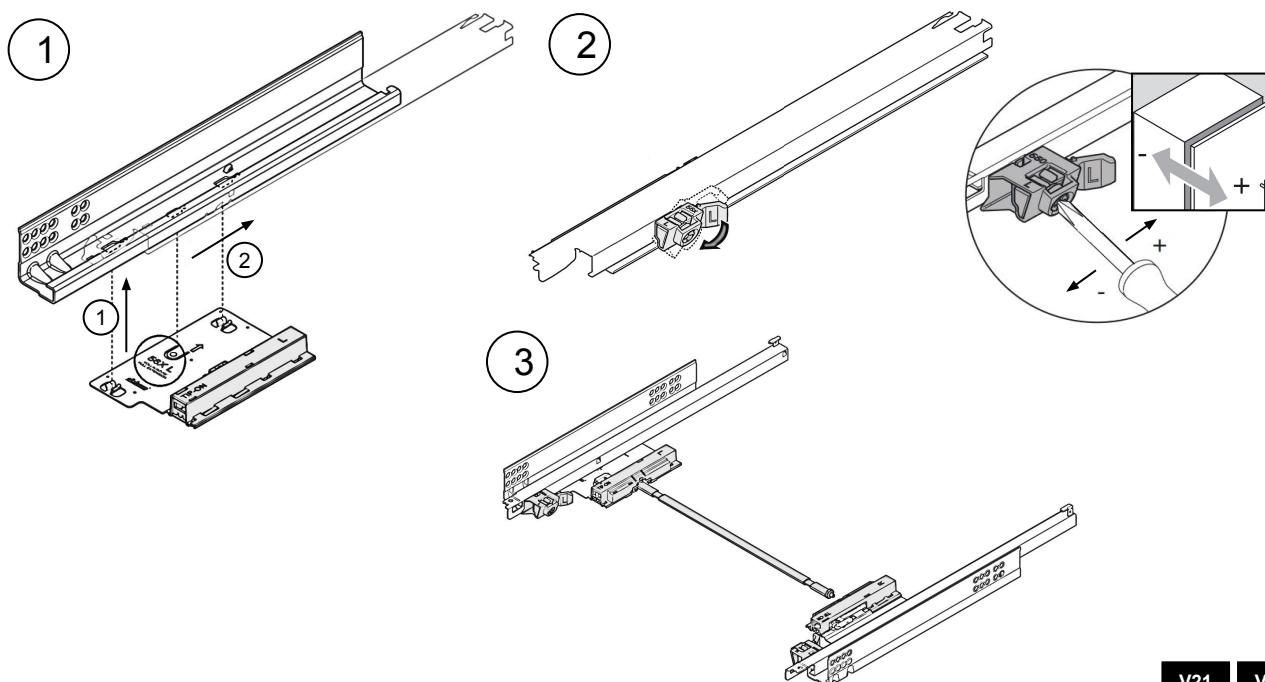

V21 V24

For drawers with Push-To-Open functionality, install the supplied elements (V24) on the rails (V21) and adjust the position if necessary.

Note: The synchronizing rod shown in step 3 is only necessary for drawers wider than 60 cm.

1

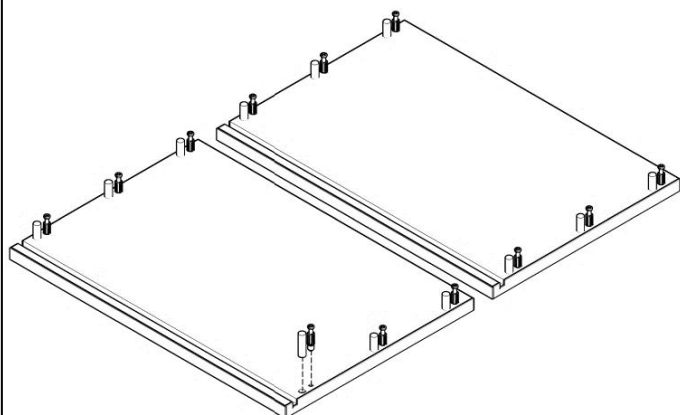

V01 V05

Place the drawer sides in front of you and screw in the eccentric screws (V01) and press in the dowels (V05).

2

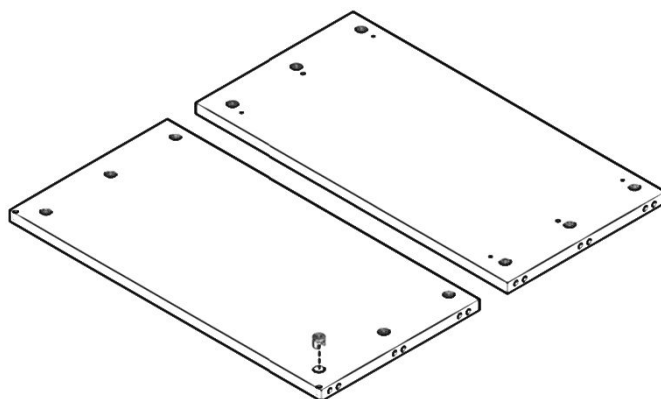

V02

Press the eccentric housings (V02) into the front and rear pieces. Make sure that the open side and the arrow point outward.

3

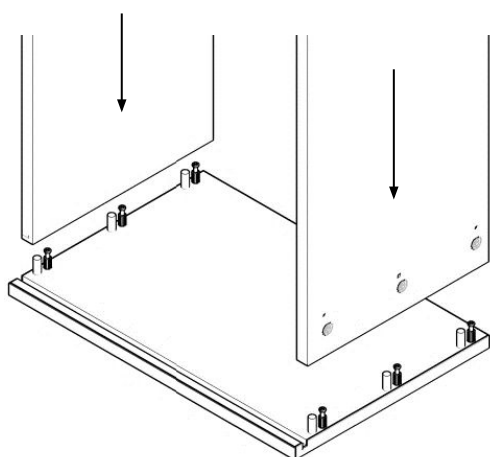

V01 V02

Attach the front and rear panels to the side panels. Then fix the housings (V02) by rotating them 180° with a screwdriver.

4

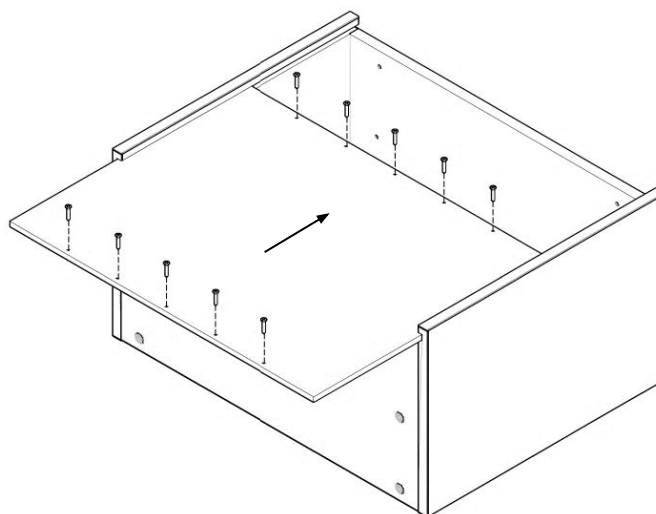

V16

Slide in the bottom. Align the bottom flush with the front edge of the drawer and fix it with the screws (V16).



5

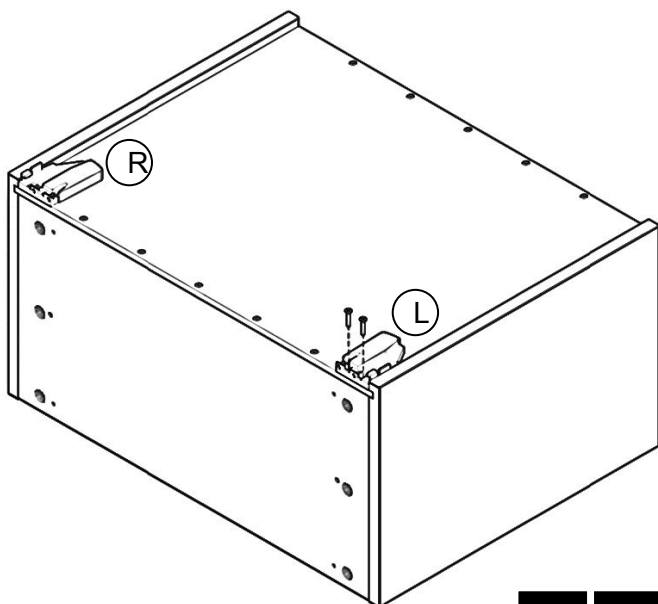

V16 V20

The couplings (V20) are labeled R and L. When screwing on the couplings, make sure that they are flush with the front edge. You can recognize the front edge by the additional holes.

6

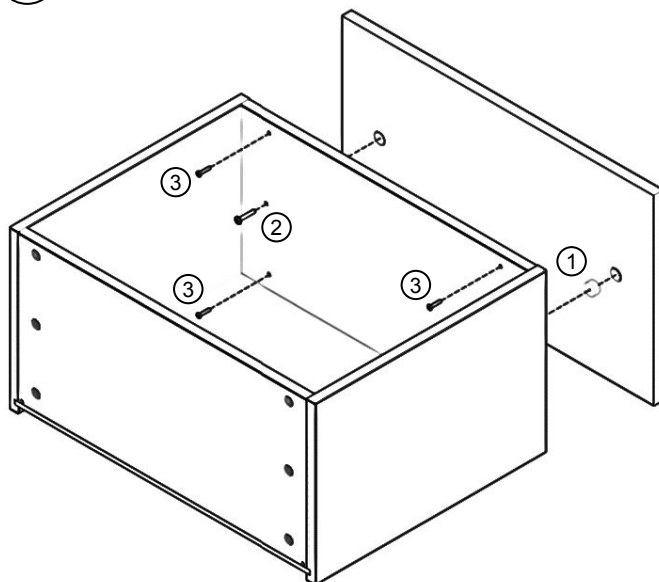

V22 V18 V16

1. Press the adjustment fittings (V22) into the cover.
2. Tighten the threaded screws (V18).

7

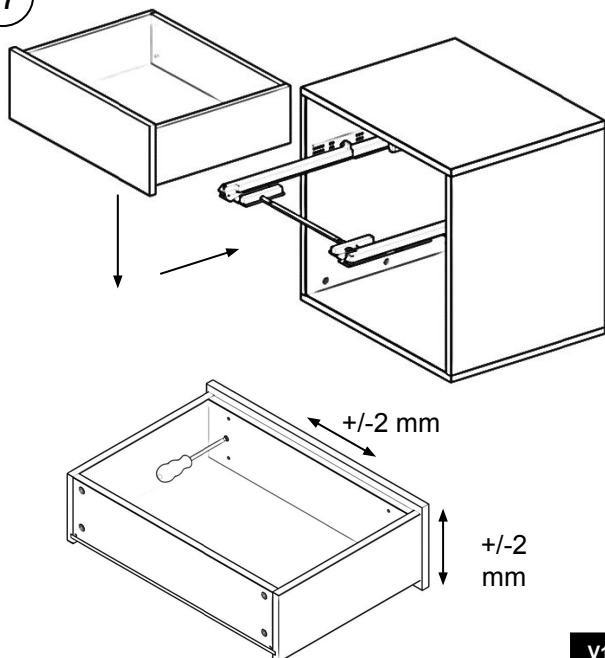

V18

Fit the drawer together with the front into the structure. Now you can loosen the threaded screws (V18) a little to adjust the front.
3. Screw the wood screws (V16) tightly.

8

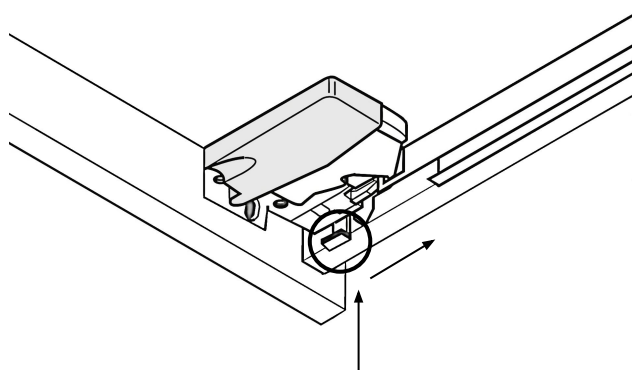

V20

To subsequently adjust the height of the drawer, move the control on the drawer coupling (V20) forwards or backwards.

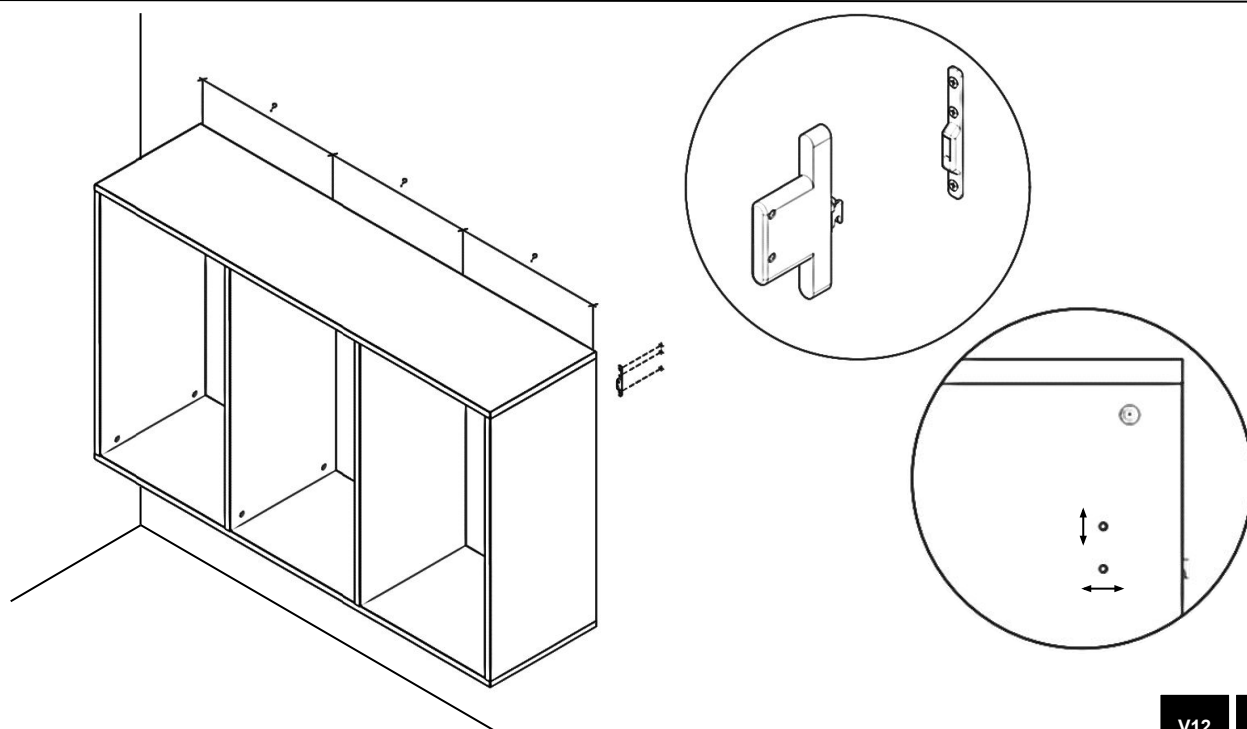

V12

V25

First measure the distances at the brackets (V25) in the cheeks. Transfer these to the wall using a spirit level. Now drill and screw (V12) the counter plates onto this. You can then hang the shelf.
Important note: Use the adjusting screws to pull the furniture against the wall and adjust its height.
You will need an allen key for this.

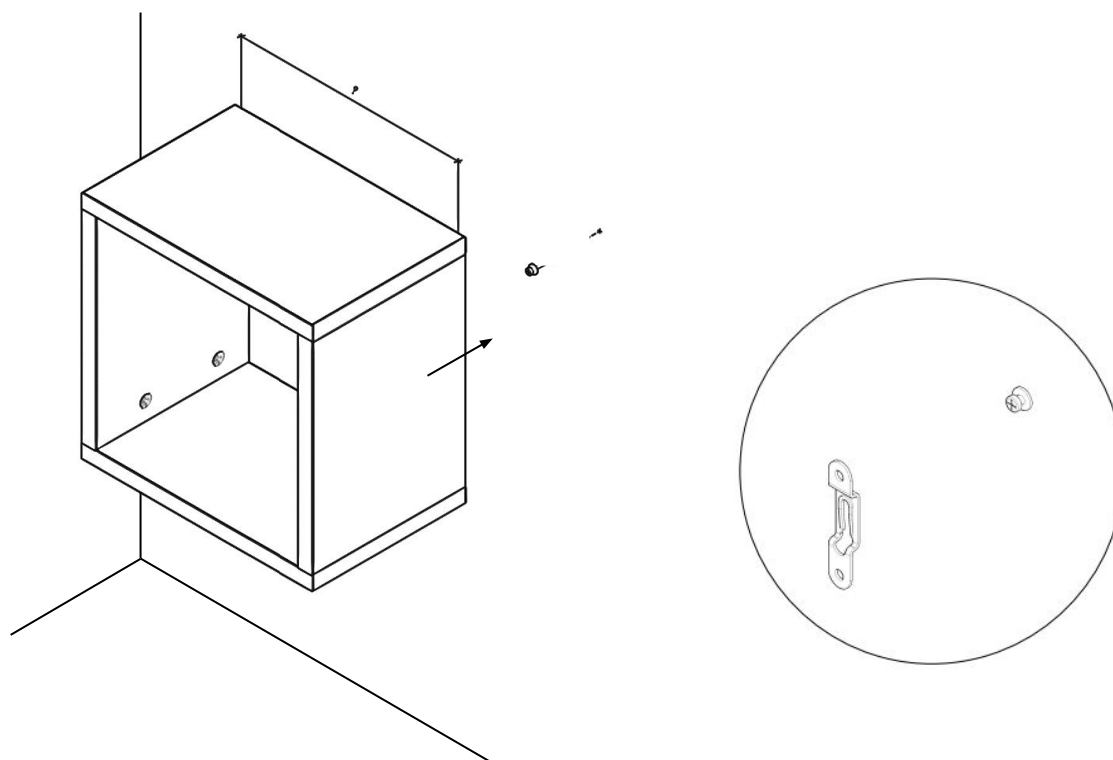

V26

Wall cubes are mounted by first measuring the distances between the brackets in the cheeks. Transfer these distances to your wall using a spirit level. Drill the holes for the screws (V26) and attach them to the wall. You can then mount the Cube.





Book assembly afterwards:



<https://www.pickawood.com/en/advice-service/montage>

If you have any questions, please contact us by e-mail or telephone. We will be happy to help you!



Mail: support@pickawood.com

Telefon: 0330 808 4870

Web: www.pickawood.com

Amsinckstraße 34, 20097 Hamburg, Germany